

16g Replacement Dress Cover Seat Fire-blocking Checklist

Page 1 of 15

Company Name:		Contact Name:	
Phone:	E-Mail:		
Requested Completion Date:		P.O. #:	
Aircraft Make:	Model:	S/N #:	Tail #:
Does Skandia have your permission to fabricate test specimens and issue FAA 8130-9 forms on your behalf? <input type="checkbox"/> Yes <input type="checkbox"/> No			
1. Is Test Data in support of AC 21-25B TSO Modification? Yes No			
2. Does the seat currently have modification tag(s) installed next to the TSO tag? Yes No			
Please provide pictures of the current TSO tags for all applicable seats.			

Major Repair

Major Alteration

SEATING CONFIGURATION:

Number of: Single Passenger Seats _____ Double Passenger Seats _____ Divans _____
 Lav Seats _____ Jumpseats/Flight _____ Crew Seats _____
 Attendant Seats (FAS) _____

Verification of Dress Cover Replacement Only

Seat Manufacturer: _____

PLEASE NOTE:

Re-upholstery of a seat can affect its certification basis. The modifier may be required to do additional testing or gain additional approvals to maintain airworthiness approval.

*All aircraft seats require flammability testing for all components of the seat (armrest, shrouds, close-out, drawers, etc.) tested in the "as installed state" per 14 CFR 25.853(a).

SEAT COMPOSITE TESTS:

TO BE TESTED?

IS SKANDIA FABRICATING?

ARMREST	YES _____	NO _____	YES _____	NO _____
SEAT SHROUDS	YES _____	NO _____	YES _____	NO _____
SEAT BASE	YES _____	NO _____	YES _____	NO _____

16g Replacement Dress Cover Seat Fire-blocking Checklist

Page 2 of 15

<u>Seat Part Numbers</u>	<u>Seat Serial Numbers</u>	<u>Seat Part Numbers</u>	<u>Seat Serial Numbers</u>

16g Replacement Dress Cover Seat Fire-blocking Checklist

Page 3 of 15

ITEMS REQUIRED TO COMPLETE FIRE-BLOCKING:

TEST PLAN PROCESS DOES NOT BEGIN UNTIL ALL MATERIALS AND PAPERWORK HAVE BEEN RECEIVED.

- 3 Copies of INVOICES OR PACKING LISTS providing traceability for all fabricating components used in production including: dress cover(s), foam(s), glue, thread, fastener, muslin, canvas, batting, and all other materials used in production cushion assembly.
- 4 Please take pictures of *each* different cushion assembly: backs, bottoms, headrests, legrests/footrests, and armrest. Include dimensions and armrest buildups on pages 7-13 of this checklist. It is very important to simulate the placement of any hook and loop attachment strips that may attach either back or bottom assemblies to the seat frame. Please make sure these are included.

- 5 For each different dress cover or cushion buildup: LEATHER: 75 square feet; or 12 pieces cut 32"x32"; or 85 sq. ft. window pane with leather close-out; or 80 sq. ft. fully encapsulated with 2" hook and loop

* Additional charges will be assessed for receiving scrap pieces.

FABRIC: 40" – 48", 6 yards

49" – 53", 5 yards

54" – or more, 4 yards

Add ½ yard more of additional fabric for window pane dress cover close-out.

Oil Burn: All materials for oil burn must pass a vertical burn test. If you are supplying materials for an oil burn test, please provide enough material for the vertical burn test.

6. 12- and 60- Second Verticals less than .25": Woven specimens (fabric, carpet, etc.) three strips, 3"x12" cut from across the roll AND three strips, 3"x12" cut from up the roll. NON-woven specimens (leather, vinyl, plastic, foam, etc.) three strips, 3"x12". 12- and 60-second more than .25": Woven specimens (fabric, carpet, etc.) six strips, 3"x12" cut from across the roll AND six strips, 3"x12" cut from up the roll. NON-woven specimens (leather, vinyl, plastic, foam, etc.) six strips, 3"x12".

7. Per FAA Handbook, DOT/FAA/AR-00/12 Chapter 1.0, when testing two samples per 1.6.2.4 for test specimens greater than 0.25" (6.35 mm), the recorded burn length will be from the face with the greatest burn length in accordance with section 1.6.2.9

PLEASE NOTE: Extra leather or fabric may be required for composite panel testing. Additionally, you may be required to send a small quantity of your adhesive if it is not stocked at Skandia. We will make every effort to stock your glue.

8. Is padding or batting/muslin used on seating surfaces? Yes No Only .25" padding/batting can be used on the OLA bottom cushion. Only lowest density DAX 26 can be used on the OLA bottom cushion, DAX 26 with treatment, scrim or jersey scrim is permissible.

If so, how is it held in place?

Glued

Placed

Stitched at Seams

Quilted to Dress Cover

9. If fireblocking material is being used, how is it used?

Glued on seating surface only

Placed on seating surface only

Fully encapsulated

Fully encapsulated
with stitched seams

Fully encapsulated
with glued seams

and bonded to foam

10. Do you have a copy of the original report or copies of the original production drawings? Yes No
If "Yes", please provide accordingly.

16g Replacement Dress Cover Seat Fire-blocking Checklist

Page 4 of 15

Original foam assembly drawing numbers listed below:

10. Seam Closure: See examples on page 5 and mark below with corresponding number.

A. Single Passenger Seat Seam Closure:

Back: _____

Bottom: _____

If "window pane", what is the close-out material?

B. Double Passenger Seat Seam Closure:

Back: _____

Bottom: _____

If "window pane", what is the close-out material?

C. Divan Seat Seam Closure:

Back: _____

Bottom: _____

If "window pane", what is the close-out material?

D. Lav Seat Seam Closure:

Back: _____

Bottom: _____

If "window pane", what is the close-out material?

E. Jump-Seat/FAS Seam Closure:

Back: _____

Bottom: _____

If "window pane", what is the close-out material?

F. Headrest Closure: _____

If "window pane", what is the close-out material?

G. Legrest/Footrest Closure: _____

If "window pane", what is the close-out material?

16g Replacement Dress Cover Seat Fire-blocking Checklist

Page 5 of 15

SEAM CLOSURE EXAMPLES

Glued Window Panel #1

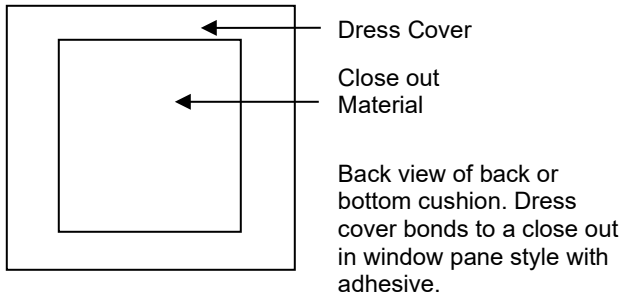

Fastened Window Panel #2

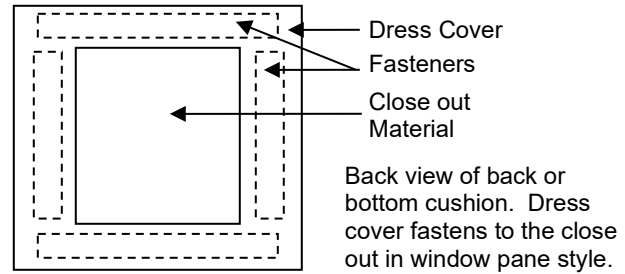

**Fastened Side Seam #3
End View**

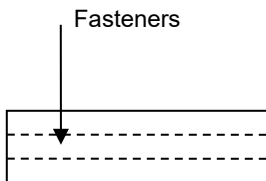

**Glued Side Seam #4
End View**

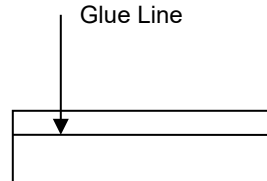

**Stitched Side Seam #5
End View**

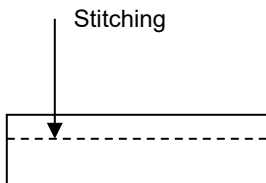

Flap Closure #6

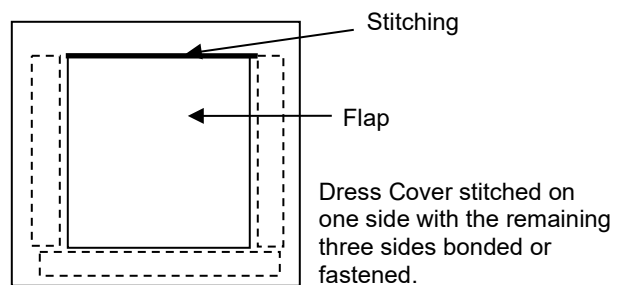

16g Replacement Dress Cover Seat Fire-blocking Checklist

Page 6 of 15

MATRIX FOR PRODUCTION ARTICLES

Select appropriate box, mark with an "X", tab to next

CHECK APPLICABILITY

	VENDOR	PART NUMBER	INVOICES or PACKING SLIPS ENCLOSED	PAX SEATS	DIVAN	JUMP SEAT/ FAS	LAV SEAT	HEAD REST	FOOT REST	FLAME TRMT
DRESS COVER										
DRESS COVER										
DRESS COVER										
FOAM										
FOAM										
FOAM										
SCRIM-BACKED FOAM										
BATTING										
MUSLIN										
FIRE-BLOCKER										
ADHESIVE										
FASTENER										
FASTENER										
CLOSE-OUT FABRIC										
ADHESIVE/ FASTENER										
Other:										
Other:										

Comments:

16g Replacement Dress Cover Seat Fire-blocking Checklist

Page 7 of 15

Foot Rest removed For Clarity

Arm Rest Removed For Clarity

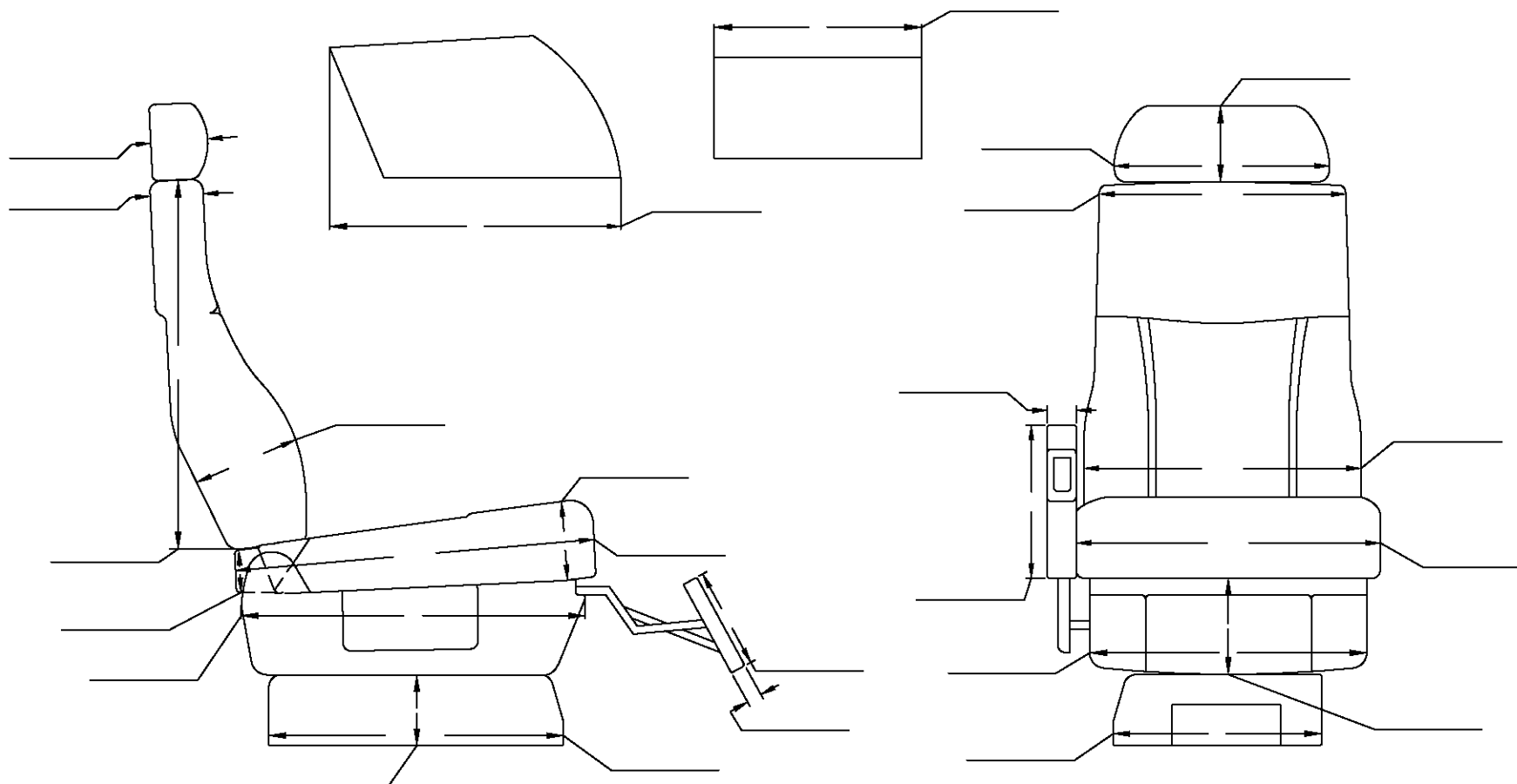

Seat Dimension Drawing Single Seats
Refer back to # 4 Page 3

FL 106-18 Rev. N Release Date: 08/08/22

Skandia, Inc. • 5000 N. Highway 251 • Davis Junction, IL 61020 • 815/393-4600 • 815/393-6878 fax • Info@Skandialnc.com

16g Replacement Dress Cover Seat Fire-blocking Checklist

Page 8 of 15

Arm Rest Removed For Clarity

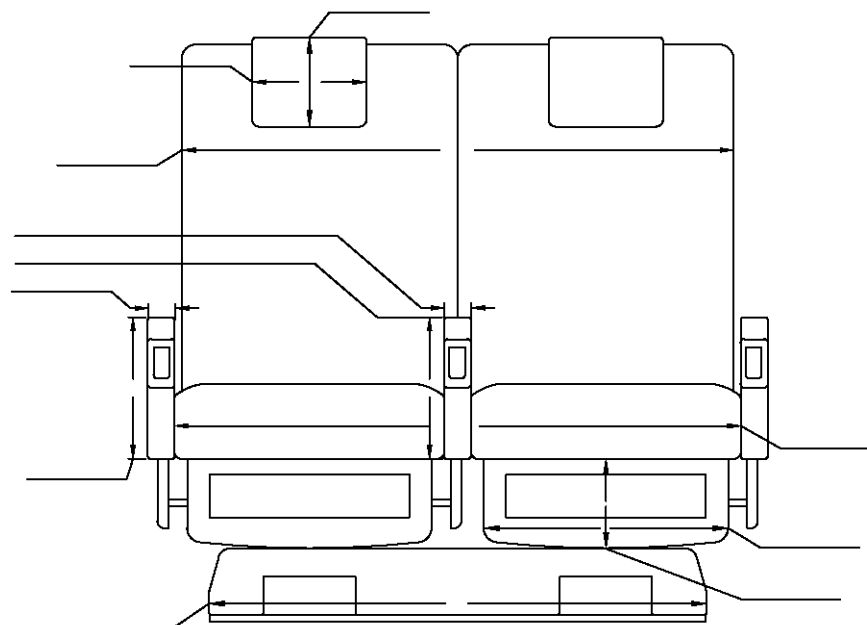
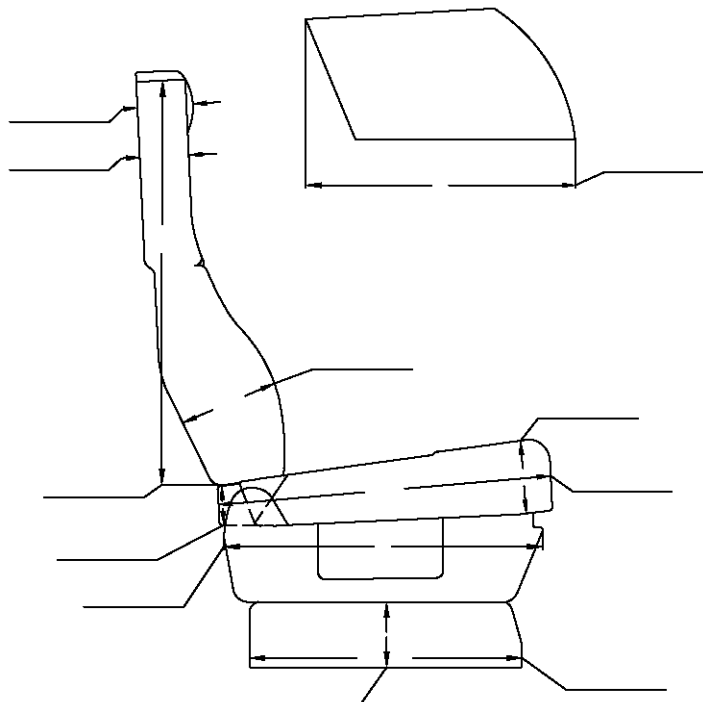

Seat Dimension Drawing Double Seats
Refer back to # 4 Page 3

16g Replacement Dress Cover Seat Fire-blocking Checklist

Page 9 of 15

Arm Rest Removed For Clarity

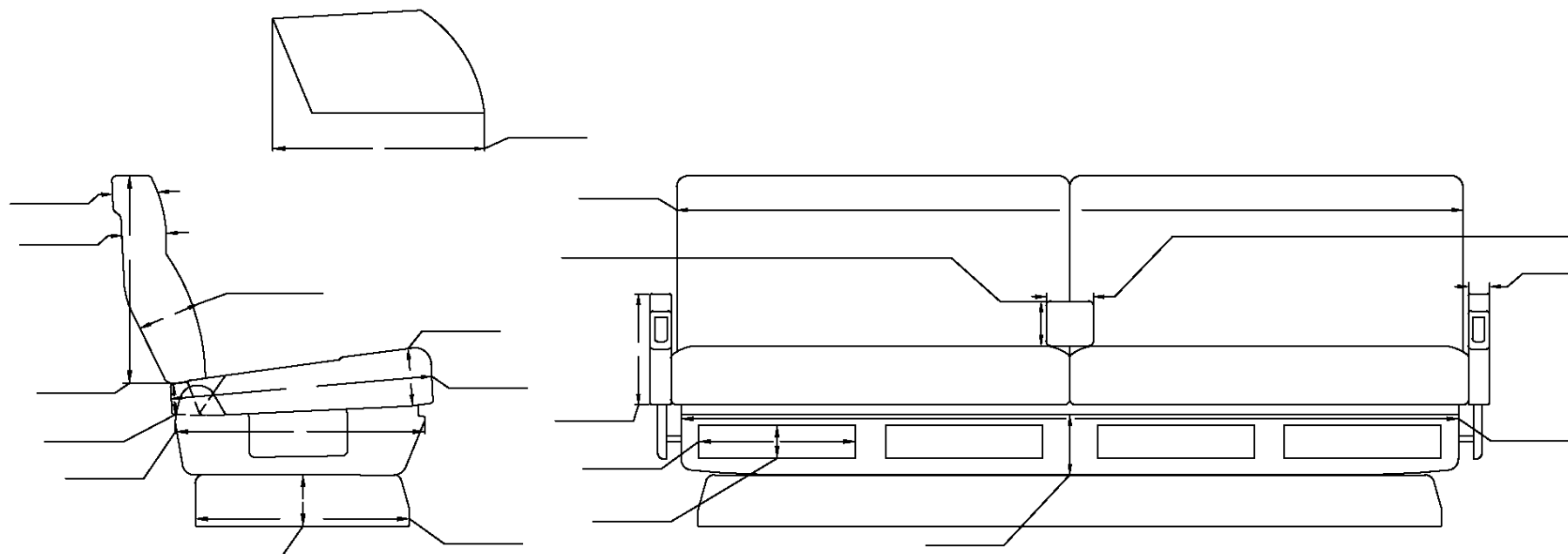

Seat Dimension Drawing Divan

Refer back to # 4 Page 3

FL 106-18 Rev. N Release Date: 08/08/22

Skandia, Inc. • 5000 N. Highway 251 • Davis Junction, IL 61020 • 815/393-4600 • 815/393-6878 fax • Info@Skandialnc.com

16g Replacement Dress Cover Seat Fire-blocking Checklist

Page 10 of 15

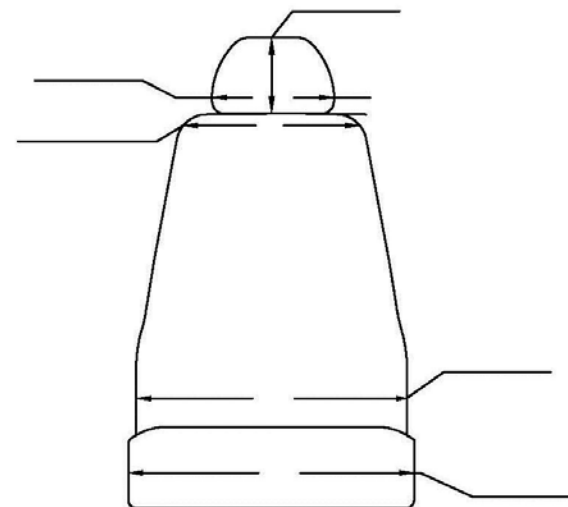
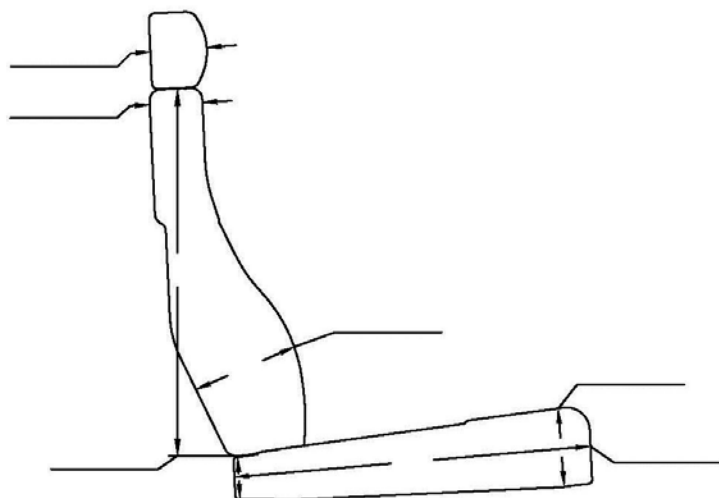

Seat Dimension Drawing Universal Seat (16G Lav, Jumpseat, FAS and/or Crew Seat)
Refer back to # 4 Page 3

16g Replacement Dress Cover Seat Fire-blocking Checklist

Page 11 of 15

List Substrate and/or Foam Build-Ups Review Note 6 on Page 3

DRESS COVERING: _____

The diagram shows a side view of a seat assembly with various components labeled for fire-blocking inspection. Red arrows point from the labels to the corresponding parts of the seat.

VERTICAL PAN PANELS

CENTER ARM REST

ARMREST PANELS

BERTHING PAN CLOSEOUT & HORIZONTAL PAN

DIVAN DRAWER FRONTS

DIVAN CAP ASSY

16g Replacement Dress Cover Seat Fire-blocking Checklist

Page 12 of 15

List Substrate and/or Foam Build-Ups Review Note 6 on Page 3

DRESS COVERING: _____

The diagram shows a top-down view of a seat with various components labeled for fire-blocking inspection. Red arrows point from the labels to the corresponding parts of the seat. Each label is followed by three horizontal lines for input.

CENTER TOP PANELS

INBOARD & OUTBOARD ARM TOP PANELS

INBOARD ARM INNER PANELS

INBOARD ARM OUTER PANELS

CENTER ARM SIDES

SHROUD

SEAT BASE

ARMREST REAR PANEL (ALL ARMS)

OUTBOARD ARM INNER PANEL

OUTBOARD ARM OUTER PANEL

FRONT PANEL (ALL ARMS)

16g Replacement Dress Cover Seat Fire-blocking Checklist

Page 13 of 15

List Substrate and/or Foam Build-Ups Review Note 6 on Page 3

DRESS COVERING: _____

ARM TOP PANELS

ARM FRONT PANELS

ARM INNER PANELS

FOOTREST FRONT PANELS

LIFEVEST COVER

ARMREST BACK PANELS

ARMREST OUTER PANELS

SHROUD

FOOTREST

SEAT BASE

16g Replacement Dress Cover Seat Fire-blocking Checklist

Page 14 of 15

EXAMPLE

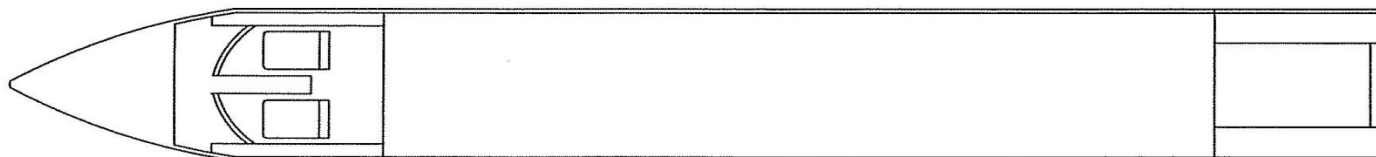
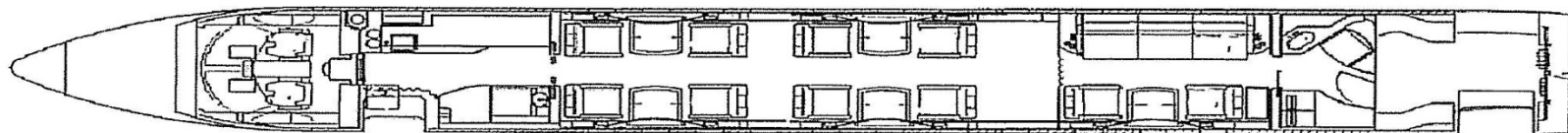

PLEASE FILL IN ACCORDINGLY

***Please include seat part numbers and serial numbers when indicating seat position.

FL 106-18 Rev. N Release Date: 08/08/22

Skandia, Inc. • 5000 N. Highway 251 • Davis Junction, IL 61020 • 815/393-4600 • 815/393-6878 fax • Info@Skandialnc.com

16g Replacement Dress Cover Seat Fire-blocking Checklist

Page 15 of 15

Referring back to # 4 Page 3, it is very important to simulate the placement of any hook and loop attachment strips that may attach either back or bottom assemblies to the seat frame. Please document dimensional placement. Please note which direction is the FRONT or TOP of the cushion.

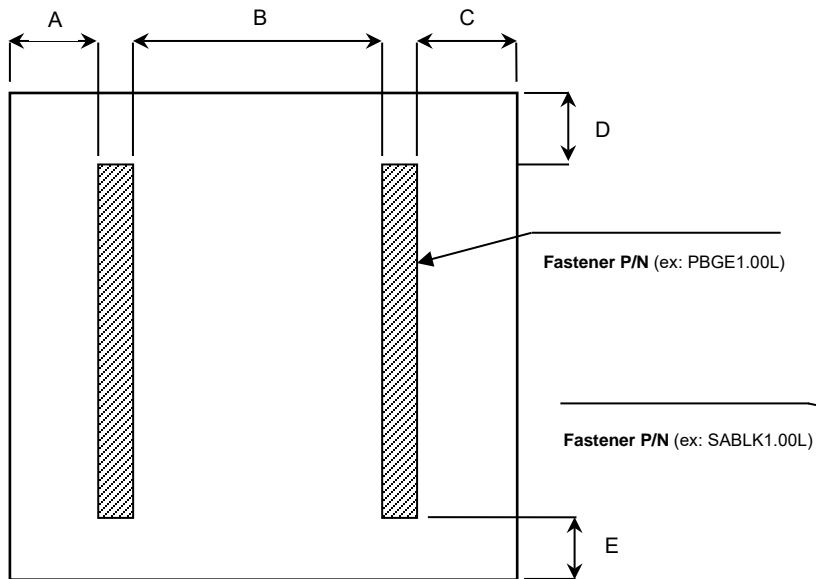

Back Cushion

A: _____

B: _____

C: _____

D: _____

E: _____

Length of Fastener: _____

Fastener Part No.: _____

Is the attach strip Hook/Loop on the cushion new or existing? _____ (Please indicate Hook or Loop)

Is the attach strip Hook/Loop on the seat frame new or existing? _____

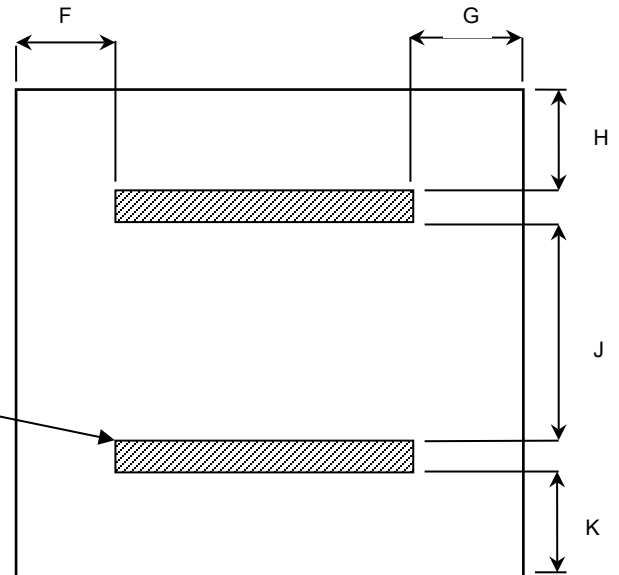

Bottom Cushion

F: _____

G: _____

H: _____

J: _____

K: _____

Length of Fastener: _____

Fastener Part No.: _____